

TESA-HITE® 400/700 Outstanding Price/Performance Relationship

Over 25 years of technology and innovation have resulted in a height gage that offers exceptional features at an attractive price. Sure to become an essential part of any workshop production area, the new TESA-HITE 400 and 700 offer a generous 16" and 28" measuring span (respectively). The electronics are completely protected against liquid and dust penetration and they feature a built-in air cushion and fixed panel. Automatic diameter measurements can be taken using TESA's patented system for determining the culmination point.

.00001 in / .0001 in /
.001 in or .00001
mm / 0.001 mm /
0.01 mm

**Accuracy: (2.5+4L) µm
(L in m)
16" (400 mm) and 28"
(700 mm)
measuring span**

- 16" (400 mm) and 28" (700 mm) measuring range
- Electronics completely protected against liquids or dust penetration
- Built-in air cushion and fixed panel
- Automatic diameter measurement using TESA's patented system which determines the culmination point
- Parallelism and perpendicularity measurements
- TESA opto-electronic measuring system (patented)
- Compatible with TESA MICRO-HITE accessories, including measuring inserts and holder
- SCS calibration certificate delivered with each instrument

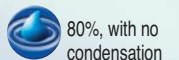
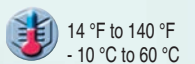
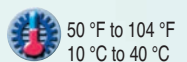
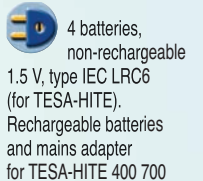
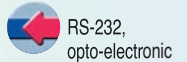
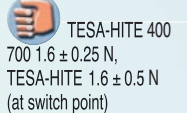
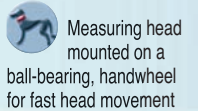
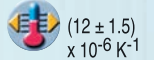
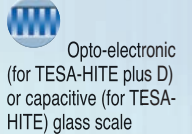
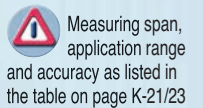
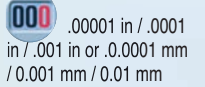

 EN 50081-1,
 EN 50081-2,
 EN 50082-1, EN 50082-2
 (with use of mains
 adapter excluded)

 Transport
 packing

 Identification
 number

 Declaration
 of conformity

 SCS Calibration
 certificate

TESA-HITE® 400/700



Technical specifications	TESA-HITE 400	TESA-HITE 700
Order number	00730043	00730044
EDP number	24675	24676
Measuring span	16 in / 415 mm	28 in / 715 mm
Application range with standard insert holder 00760143	22 in / 570 mm	34 in / 870 mm
Application range with standard insert holder 00760057	24 in / 625 mm	36 in / 925 mm
Application range with standard insert holder S07001622	31 in / 795 mm	43 in / 1095 mm
Max. perm. error	(0.0001+0.000004L) in (L in in) /	(2.5+4 L) µm (L in mm)
Repeatability flat surface (2s)	<0.0001 in / <2 µm	<0.0001 in / <2 µm
Repeatability within bores (2s)	<0.00015 in / <3 µm	<0.00015 in / <3 µm
Max. deviation in perpendicularity (frontal)	0.0004 in / 10 µm	0.0006 in / 15 µm
Resolution	.00001 / .0001 / .001 in 0.0001 / 0.001 / 0.01 mm	.00001 / .0001 / .001 in 0.0001 / 0.001 / 0.01 mm
Displacement speed	0.5 m/s	
Measuring force (acoustic signal)	1.5 N ±0.5 N	1.5 N ±0.5 N
Power	60 h	60 h
Weight	27 kg	32 kg
Air cushion	✓	✓
Power supply	6V rechargeable battery	6V rechargeable battery
Data output	RS-232	RS-232
Degree of protection	IP40; electronic panel IP65	IP40; electronic panel IP65
Probe head lock	✓	✓
Fine adjustment	✓	✓
Storage temperature range	-10°C to 60°C	-10°C to 60°C
Operating temperature range	10°C to 40°C	10°C to 40°C

TESA-HITE® 350 / 600



07.30041 28384 **TESA-HITE Height Gage, Model 350**
 Measuring span 14 in / 365 mm
 Application range 0 to 20 in / 0 to 520 mm

07.30042 28385 **TESA-HITE Height Gage, Model 600**
 Measuring span 24 in / 615 mm
 Application range 0 to 30 in / 0 to 770 mm

Each model is supplied with the following standard accessories:

07.60168	26878	1 Standard insert holder
07.60164	26879	1 Standard insert with a 5 mm dia. carbide ball tip
07.60169	26867	1 Master piece for determining the probe constant
47.68002	42748	1 Set of 4 batteries, 1.5 V, type IEC LRC 6



The standard accessories are pictured on page K-23.



Fast, Simple Measurement Programs

TESA- HITE features programmed routines for the most commonly used measurement functions. So you can make complex measurements faster, more accurately and far more efficiently than ever before.

Point-to-Point Program

Establish zero at any point and subsequent measurements are automatically calculated from the zero reference. Press the Delta key to recover the difference between any two measurements previously taken. Effortlessly.

Centerline-to-Centerline

Calculates center-to-center distances between grooves, holes, studs and other features on a workpiece. Automatically.

Indirect Reference Program

Enter numerical values for a reference plane which cannot be directly contacted by the probe and the TESA-HITE measures distances from the indirect reference to any surface of the workpiece. Precisely.

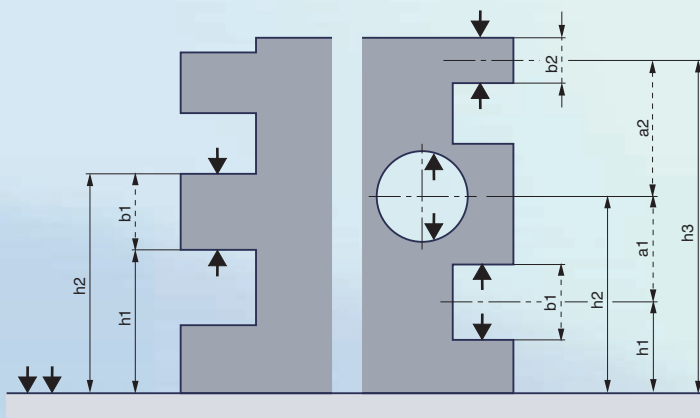
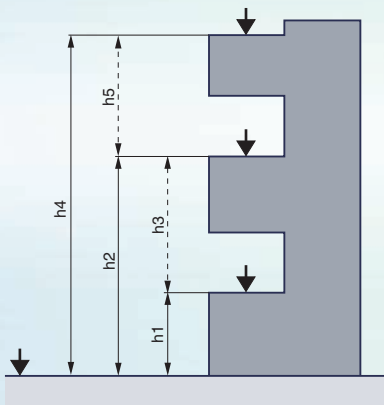

Technical Data

Models	TESA-HITE		
	350	600	
	14	24	
	mm 365	615	
	with std accessories	in 0 - 20	0 - 30
		mm 0 - 520	0 - 770
	with insert holder	in 0 - 22	0 - 32
	No. 07.60057	mm 0 - 575	0 - 825
	with std accessories	in 0.0006	0.0008
		μm 15	20
	with std accessories	in 0.0002	0.0002
		μm 5	5
		in -	-
		μm -	-
	kg 14	16.1	

The limiting values assigned to the perpendicularity error (frontal) are valid for the max. distance of 4.72 in / 120 mm from the front face of the height gage.

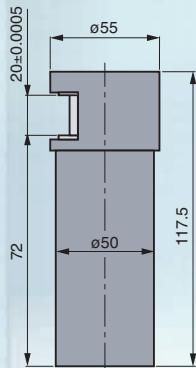

07.60150

Standard Accessories for TESA-HITE® 400 and TESA-HITE® 700

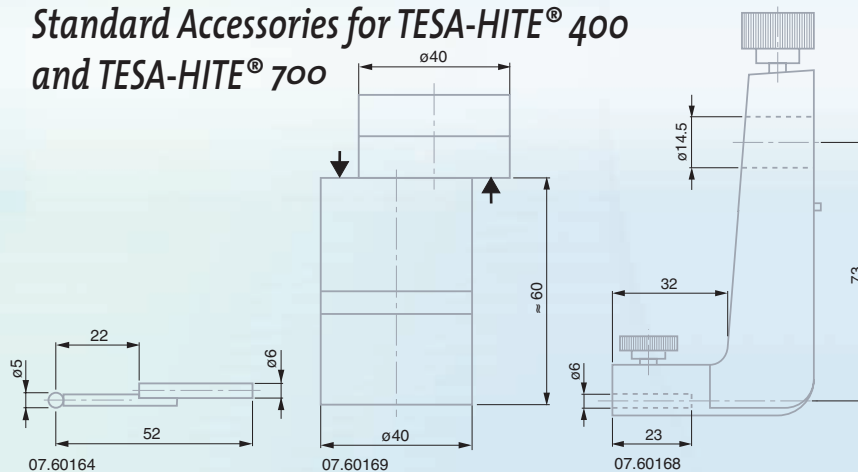

07.60164

07.60169

07.60168

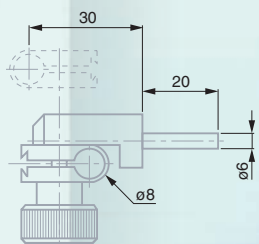

07.60166

Optional Accessories for TESA-HITE® plus D and TESA-HITE®



07.60165	26763	Tungsten carbide tipped scriber with centering ring for safety operating (only for TESA-HITE)
07.60166	26762	Fixing shank for dial test indicators, dial gages, etc.
07.60151	86960	Dust cover for model 350
07.60152	86959	Dust cover for model 600

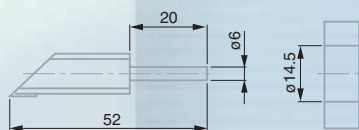

07.60165

